



# ROCKFORD SEPARATORS

5159 28th Ave ROCKFORD, IL 61109

(815) 229-5077 - FAX (815) 229-5108

www.rkfdseparators.com - rssem@rkfdseparators.com

**MODEL NO. RCB-840**

**CATCH BASIN/SAND INTERCEPTOR**

**DRAWN BY R.P.P.**

**QUOTE#:**

**DATE: 03/08/24**

**JOB NAME:**

OPTIONAL FEATURES (ADDITIONAL COST)

- ☐ ANCHOR FLANGE
- ☐ EPOXY COATING
- ☐ LIGHT TRAFFIC REINFORCED COVERS
- ☐ HEAVY TRAFFIC H20 REINFORCED COVERS
- ☐ STAINLESS STEEL CONSTRUCTION
- ☐ INTEGRAL EXTENSION \_\_\_\_\_ INCHES
- ☐ INLET & OUTLET SIZE \_\_\_\_\_ INCHES
- ☐ AUXILIARY INLET TAPPING

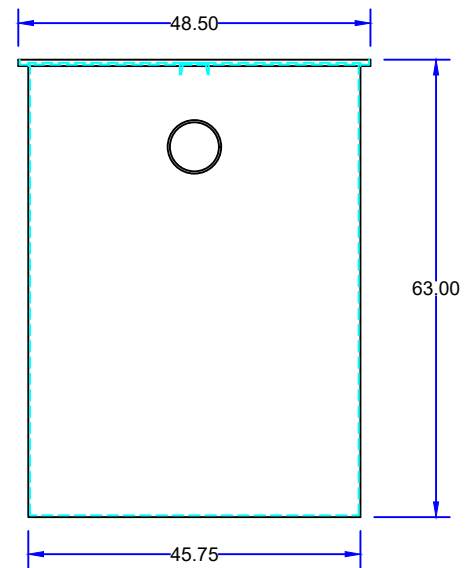
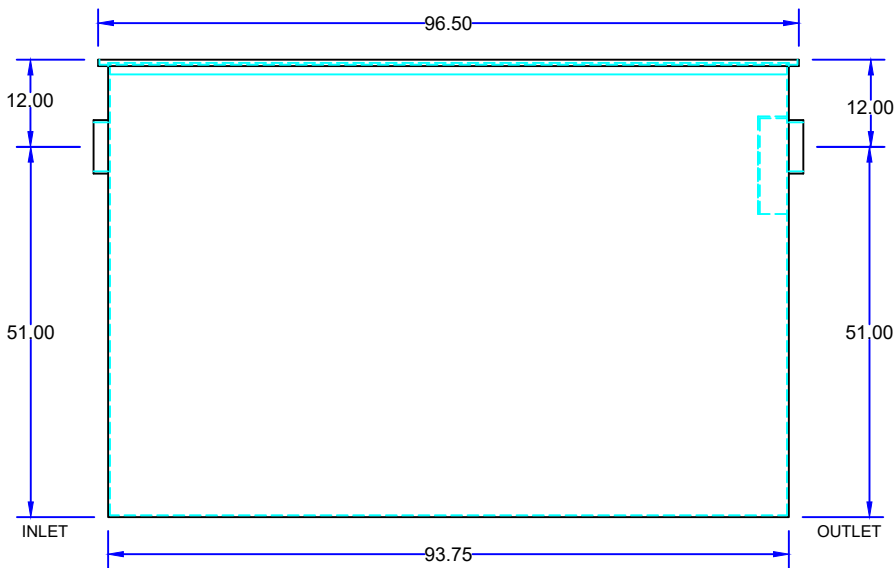
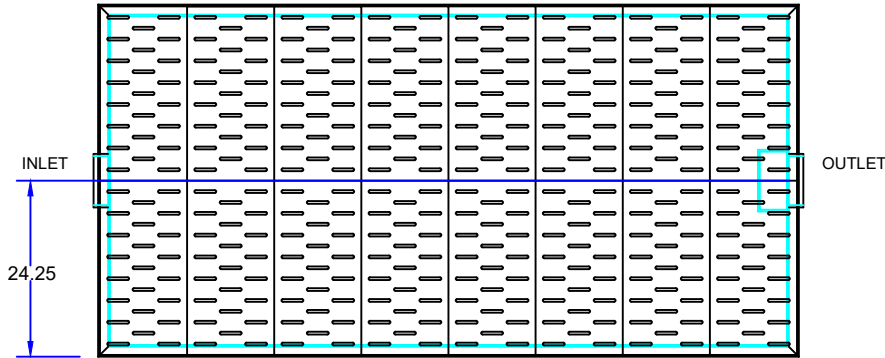

## SPECIFICATIONS

Rockford Model RCB-840 catch basin/sand Interceptor all welded A36 1/4" steel, 840 gallon static capacity, 6.00" Threaded inlet/outlet with outlet trap seal (16) 3/8" slotted grates (for flush-with-floor installation) for pedestrian traffic, OPEX SHOP COAT coating inside & bituminous coating outside.

**Optional features (Additional cost) listed above**

**Approved By**

**Company**

**Date**