



# ROCKFORD SEPARATORS

5159 28th Ave ROCKFORD, IL 61109

(815) 229-5077 - FAX (815) 229-5108

www.rkfdseparators.com - rssem@rkfdseparators.com

MODEL NO. ROI-750

OIL / SAND INTERCEPTOR

DRAWN BY R.P.P.

QUOTE#:

DATE: 07/25/22

JOB NAME:

Note: Standard unit includes 6" manway base.  
Additional manway height can be made to  
accommodate inlet invert requirements.

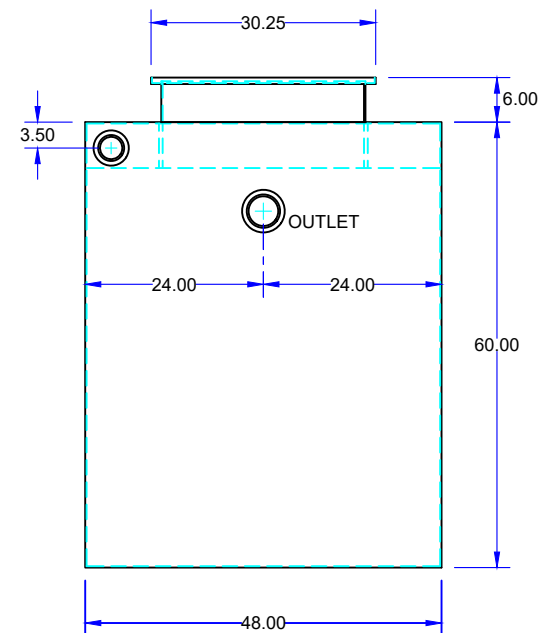
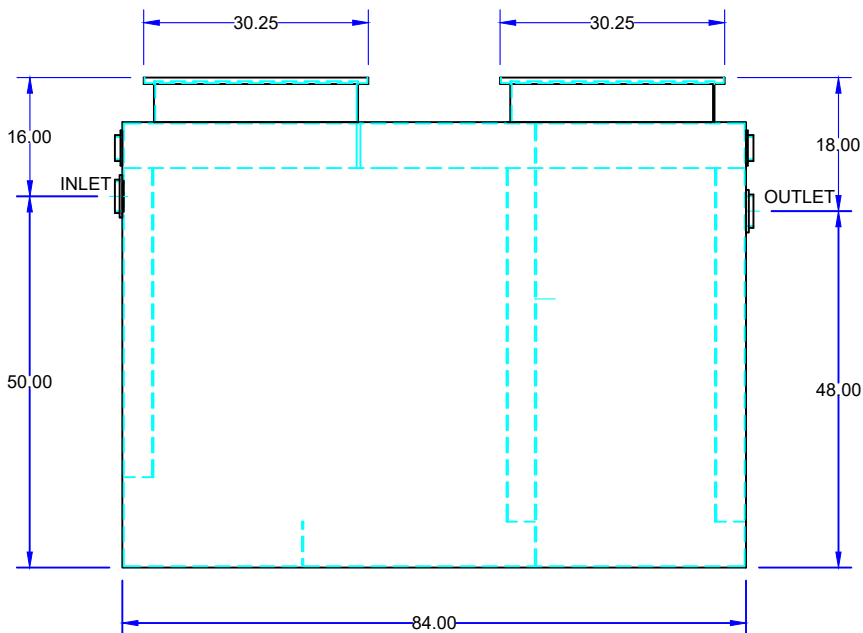
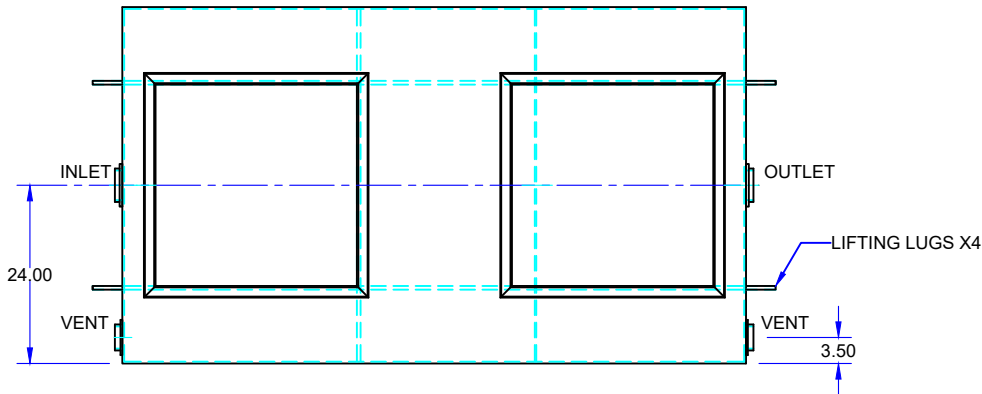

## OPTIONAL FEATURES (ADDITIONAL COST)

- ☐ ADDITIONAL \_\_\_\_\_ MANWAY HEIGHT REQUIRED
- ☐ INLET & OUTLET SIZE \_\_\_\_\_ INCHES
- ☐ EPOXY COATING
- ☐ STAINLESS STEEL CONSTRUCTION
- ☐ DOUBLE WALL CONSTRUCTION
- ☐ LEAK DETECTION
- ☐ HIGH LEVEL SENSOR & ALARM
- ☐ COALESCING PACK
- ☐ PUMP OUT CONNECTION
- ☐ HOLD DOWN PADS
- ☐ RECESSED LIFT HANDLES IN COVERS
- ☐ ANCHOR FLANGE

## SPECIFICATIONS

Rockford Model ROI-750 all welded steel gravity oil/sand interceptor, with 400 intermittent GPM, 750 gallon capacity, 4" threaded inlet/outlet and 3" vent connections, removable 3/8" nonskid tread plate cover suitable for on grade or flush with grade installation. Standard with heavy traffic loading (H/20). secured with stainless steel flat head screws, heavy duty leak proof gasket, with bituminous coating outside. Supplied with lifting lugs X4. Approximate ship weight of 1900 Lbs.

Note: Standard unit includes 6" manway base. Additional manway height can be made to accommodate inlet invert requirements.

Units built to IAPMO/ANSI Z1001-2014 construction standard for fabricated gravity interceptors.

Optional features (Additional cost) listed above

Approved By

Company

Date