



# ROCKFORD SEPARATORS

5159 28th Ave ROCKFORD, IL 61109  
(815) 229-5077 - FAX (815) 229-5108  
www.rkfdseparators.com - rssem@rkfdseparators.com

**MODEL NO. SD-48**

**SEDIMENT DRAIN**

**DRAWN BY R.P.P.**

**QUOTE#:**

**DATE: 08/02/22**

**JOB NAME:**

OPTIONAL FEATURES (ADDITIONAL COST)

- ☐ ANCHOR FLANGE
- ☐ EPOXY COATING
- ☐ LIGHT TRAFFIC REINFORCED COVERS
- ☐ HEAVY TRAFFIC H2O REINFORCED COVERS
- ☐ STAINLESS STEEL CONSTRUCTION
- ☐ INTEGRAL EXTENSION \_\_\_\_\_ INCHES
- ☐ INLET & OUTLET SIZE \_\_\_\_\_ INCHES
- ☐ AUXILIARY INLET TAPPING

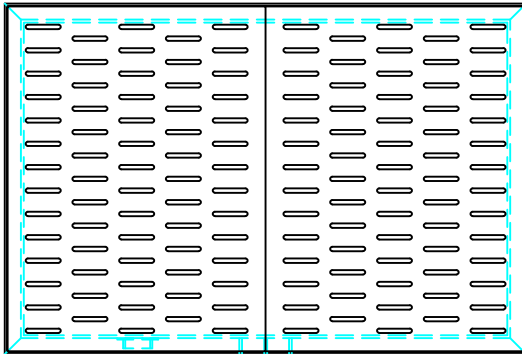

OUTLET

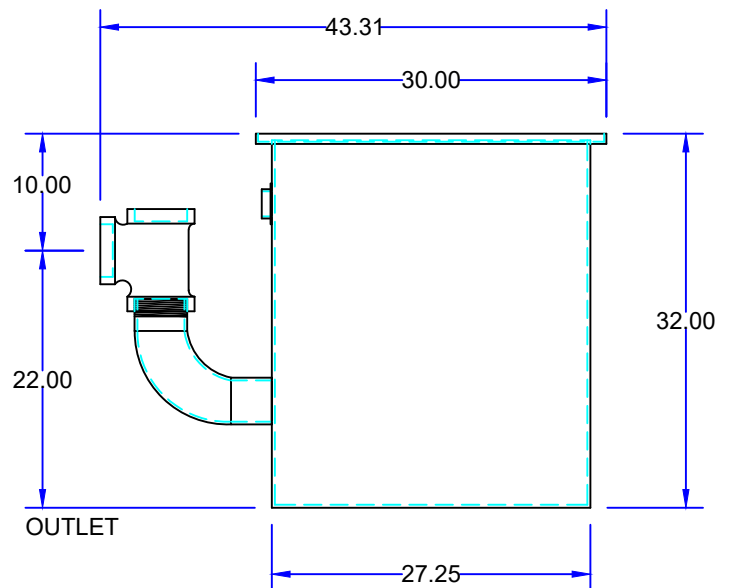
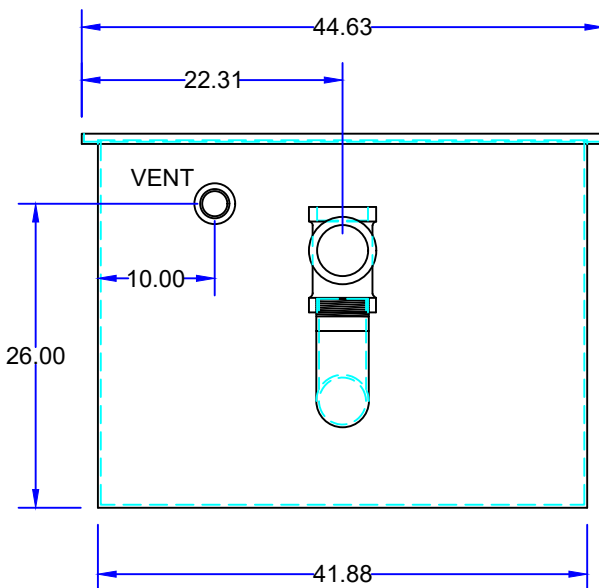

## SPECIFICATIONS

Rockford Model SD-48 Separator Drain all welded A36 1/4" steel, 100 gallon liquid holding capacity, 4.00" threaded outlet, 2.00" threaded vent connection, visible double-wall outside trap seal, removable filter screen and separator screen, slotted (.38 x 3.00) inlet grate (for flush-with-floor installation) for pedestrian traffic, OPEX SHOP COAT coating inside & bituminous coating outside.

Optional features (Additional cost) listed above

**Approved By**

**Company**

**Date**